

Fabricated, with Aseptic Connection Model TW65

WIKA Data Sheet TW 95.65

Applications

- Food and beverage industry
- Biochemical and pharmaceutical industry, production of active ingredients
- Sterile process technology, enameling lines
- For use with electrical and mechanical thermometers

Special Features

- Materials and surface finish quality according to the guide lines and standards of the pharmaceutical industry
- Quick removable measuring point cleaning without residues
- Hygienic design

Description

Material of wetted parts

Stainless steel 1.4435

Nominal size

see table page 3

Pressure ratings (static)

VARIVENT®:	25 bar
Tri-clamp, DIN 32676, ISO 2852:	40 bar
DIN 11 851:	40 bar
DIN 11 864:	40 bar

Instrument connection

Running nut (male), female thread or male thread

Pipes (Ø F₁ x s) for probe diameter

Ø 8 x 0.9 mm for probe Ø 6 mm with electrical and mechanical thermometers

Ø 12 x 1.5 mm for probe Ø 8 mm with mechanical thermometers



Thermowell with aseptic connection (running nut, male)
Model TW65

Insertion length U₁

To customer specification

Total length L

To customer specification

Optional extras

- Other dimensions and materials
- Quality certificates

Dimensions in mm

3122054.01

Instrument connections

Running nut (male)

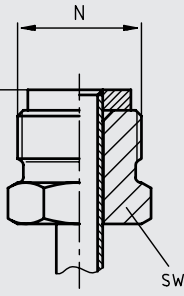

Female thread

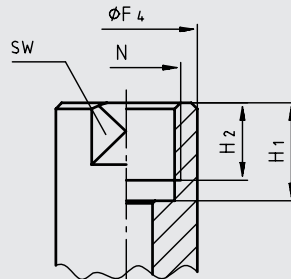

Male thread

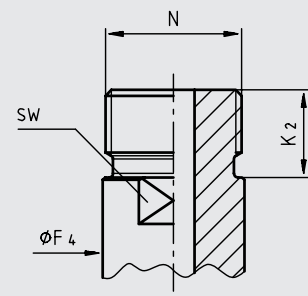

Process connections

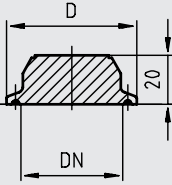

Clamp

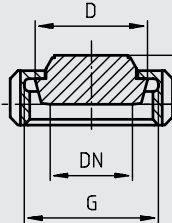

DIN 11 851

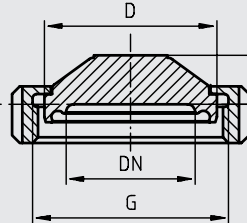

DIN 11 864-1

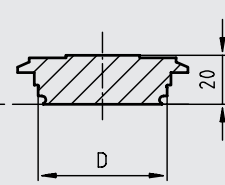

VARIVENT®

Stem

- Surface roughness
- no special requirements
 - polished Ra ≤ 0,8 µm
 - electropolished Ra ≤ 0,6 µm

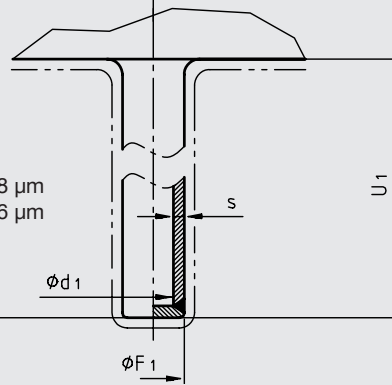

Legend:

- DN Nominal size of pipe
- D Connection diameter
- G Union nut thread
- N Instrument connection
- H₁ Bore depth for female thread
- H₂ Length of female thread
- K₂ Length of the adaptor for thermometer
- SW Flats
- Ø F₄ Head diameter
- M Extension neck length
- T Connection length
- U₁ Insertion length
- Ø F₁ Thermowell outer diameter
- s Wall thickness

Instrument connection	Maße in mm						
	N	M	H ₁	H ₂	K ₂	SW	Ø F ₄
Running nut (male)	M24 x 1.5	85	—	—	—	—	—
	G ½						
Female thread	G ½	50	19	—	15	—	27.5
	½ NPT						
Male thread	G ½ B	50	—	—	—	12	27.5
	G ¾ B						

Process connection		Nominal size	Dimensions in mm	
		DN in mm/in.	D	G
Clamp	Tri-clamp	1 ½ "	50	—
		2 "	64	
	DIN 32 676	DN 32	50	
		DN 40	50	
		DN 50	64	
		DN 51	64	
	ISO 2852	DN 33.7	50	
		DN 38	50	
DN 40		64		
DN 51		64		
Female union nut DIN 11 851 with conical coupling, for pipes acc. to DIN 11 850	DN 25	44	Rd 52 x 1/6	
	DN 40	56	Rd 65 x 1/6	
	DN 50	68.5	Rd 78 x 1/6	
Female union nut DIN 11 864-1 with liner form A, for pipes acc. to DIN 11 850	DN 40	54.9	Rd 65 x 1/6	
	DN 50	66.9	Rd 78 x 1/6	
VARIVENT ®	form F	DN 25/32	50	—
	form N	DN 40/50	68	

Suitable stem lengths for mechanical thermometers

Connection design	Stem length l ₁
S / 3 / 4 / 5	l ₁ = L - 10 mm or l ₁ = U ₁ + M - 10 mm
2	l ₁ = L - 30 mm or l ₁ = U ₁ + M - 30 mm

Modifications may take place and materials specified may be replaced by others without prior notice. Specifications and dimensions given in this leaflet represent the state of engineering at the time of printing.

